

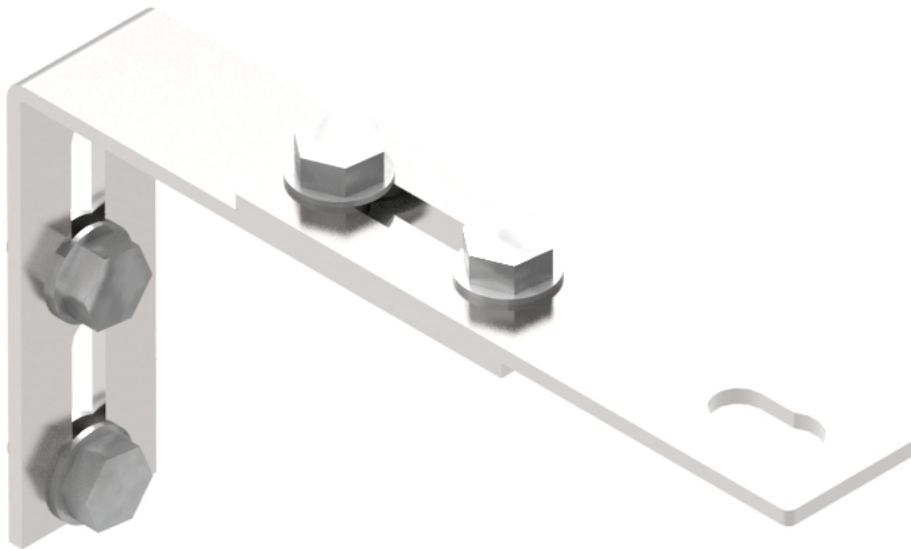

Part Number: **TC1279-161KIT**
Description: **WALL MOUNTING EXTENSION KIT,
FOR 30, 50 AND 100mm DUCT**



Use / Application:

This flexible mounting kit is used to provide a means of attaching 30, 50 and 100mm duct to any existing structure. The right-angled bracket attaches to any wall or steel work and has a slot that accepts the support bracket. The support bracket accepts a duct mounting bracket (Part No's: TC1279-14 for 100mm, TC1279-147A for 50mm & TC1279-148A for 30mm duct), and enables adjustment by the slot to slot arrangement. Maximum extension is 260mm (about 10 inches). It is not recommended for 220mm (8") duct systems where the larger TC1279-183Kit is suited.

Four M12 set screws, washers and locknuts are included for attaching the kit to existing steel - work and joining the brackets.

Benefits & Features:

- Provides vertical & horizontal mounting flexibility
- Economical
- Includes mounting bracket, four M12 set screws, four locknuts & eight washers

Technical Attributes:

Dimensions	40mm (W) x 150mm (H) x 160mm (D) (4mm thick)
Weight	600g
Materials	Mild steel, Nickel Plated finish